



4 - 5 Beds

2.5 - 4 Baths

2,215 - 3,387 Sq Ft

The Badin is a four-bedroom floor plan with the option to add an In-Law suite downstairs. Enjoy gathering with family and friends in this open-concept home which features a large great room that flows right into the kitchen. A 9-foot island and plenty of counter space will please the chef and a formal dining room is perfect for serving up family meals. Upstairs, the large owner's suite offers an ensuite bath with his and her walk-in closets. Three additional bedrooms, a hall bath and a convenient laundry room complete the second floor. An optional third floor provides a loft and full bath for additional living space. Plenty of options and upgrades are available to personalize this home and make it your own!

Available Elevations



FIRST FLOOR

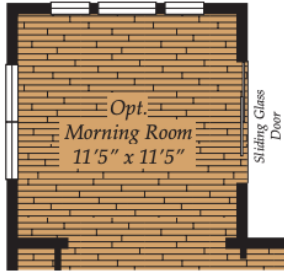

OPT. MORNING ROOM

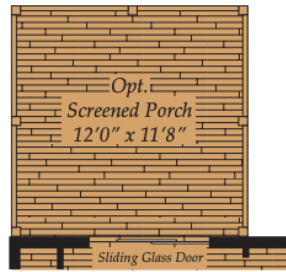

OPT. SCREENED PORCH

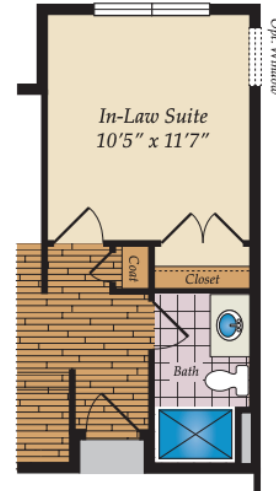

OPT. IN-LAW SUITE



SECOND FLOOR

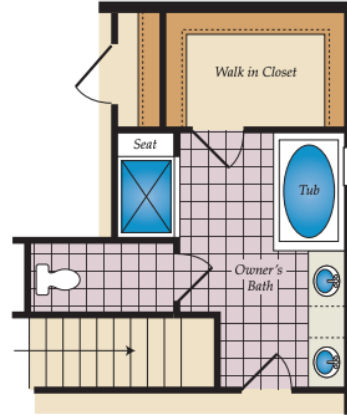

OPT. OWNER'S BATH

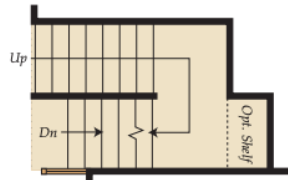

OPT. STAIRS W/LOFT

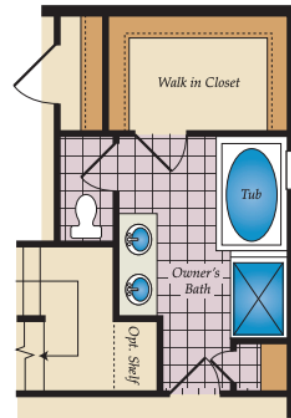

OPT. OWNER'S BATH W/LOFT

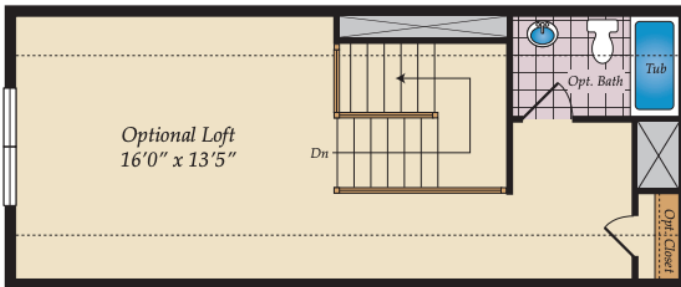

OPT. FINISHED LOFT