



4 - 5 Beds

3.5 - 6 Baths

3,494 - 5,700 Sq Ft

The Statesville is a single family estate home starting at 3,494 square feet, with options to expand up to 5,700 square feet of living space. The main level features a foyer with a formal dining room and library at the front of the home. The rear of the home has an open format with a large great room that is open to an eat-in kitchen with a walk-in pantry and large central island. This level also includes a mud room, powder room and an in-law suite with a full bath. Choose to expand the home with an optional screened porch with outdoor fireplace. The second level offers 4 bedrooms, two full baths and a spacious loft area for additional living space. The primary suite includes two huge walk-in closets and an ensuite spa bath. For those who need more bedrooms, a third floor can be added with a loft and 5th bedroom. The optional basement (where offered) can be finished to include a rec room, den and more. Select from hundreds of upgrades and finishes to personalize the Statesville into the home of your dreams.

Available Elevations



Brick/stone fronts, chimneys, bay windows, keystones, exterior trim, garage doors, light fixtures, dormers, and gables shown on elevations are optional features. Actual product specifications may vary in dimension or detail from these drawings. This insert is for illustrative purposes only and is not part of the legal contract. All dimensions are approximate. Many available options are not shown.

FIRST FLOOR



Brick/stone fronts, chimneys, bay windows, keystones, exterior trim, garage doors, light fixtures, dormers, and gables shown on elevations are optional features. Actual product specifications may vary in dimension or detail from these drawings. This insert is for illustrative purposes only and is not part of the legal contract. All dimensions are approximate. Many available options are not shown.

SECOND FLOOR

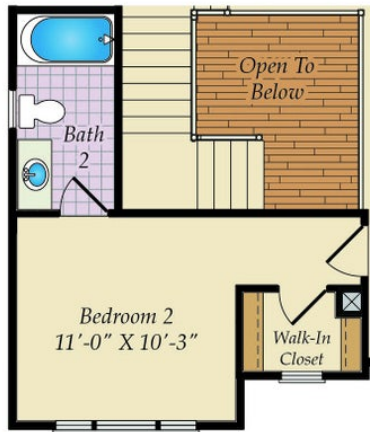

BEDROOM 2 WITH BATHROOM 2

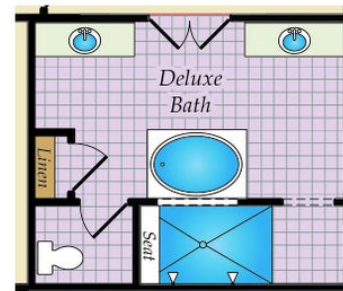

OPT. DELUXE BATH

OPTIONAL THIRD FLOOR

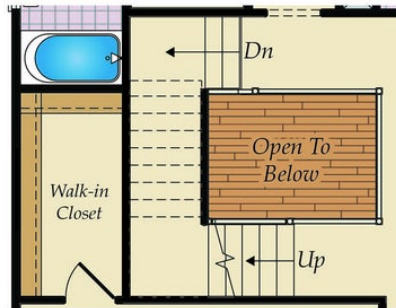

STAIRS ON SECOND FLOOR
W/ OPT. THIRD FLOOR

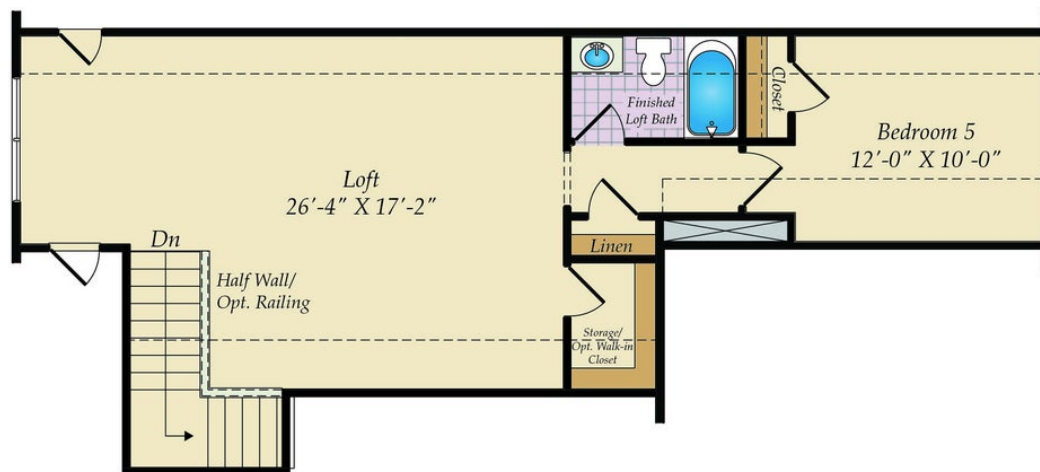

OPTIONAL THIRD FLOOR

OPTIONAL BASEMENT



FIRST FLOOR BASEMENT STAIRS



Brick/stone fronts, chimneys, bay windows, keystones, exterior trim, garage doors, light fixtures, dormers, and gables shown on elevations are optional features. Actual product specifications may vary in dimension or detail from these drawings. This insert is for illustrative purposes only and is not part of the legal contract. All dimensions are approximate. Many available options are not shown.