

**5 - 6 Beds****3.5 - 5 Baths****3,523 - 5,700 Sq Ft****COMMUNITY CONTACT**400 CORNWALLIS ROAD
GARNER, NC 27529
919-213-7778
NONE

Introducing The Statesville, an estate home featuring a 2-car garage and the flexibility to accommodate up to 5 bedrooms and 6 bathrooms, catering to families of all sizes. The main level boasts a family room that seamlessly flows into the kitchen equipped with stainless steel appliances and a generous kitchen island. You also have the option to include a Butler's pantry for added convenience. The first-floor guest suite with a full bath ensures comfort and convenience for visitors.

On the upper level, the Owner's suite awaits with spacious walk-in closets and an en-suite bath, with the possibility to upgrade to a spa-like deluxe bath. Completing the second floor is a loft area and three additional bedrooms with two baths. For those in need of extra space, The Statesville offers the flexibility to add an attic or a finished basement, providing additional room for all your lifestyle needs.

Available Elevations



FIRST FLOOR



OPT. SIDE LOAD GARAGE

Brick/stone fronts, chimneys, bay windows, keystones, exterior trim, garage doors, light fixtures, dormers, and gables shown on elevations are optional features. Actual product specifications may vary in dimension or detail from these drawings. This insert is for illustrative purposes only and is not part of the legal contract. All dimensions are approximate. Many available options are not shown.

SECOND FLOOR

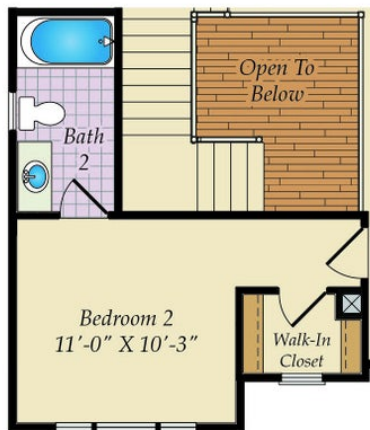

BEDROOM 2 WITH BATHROOM 2

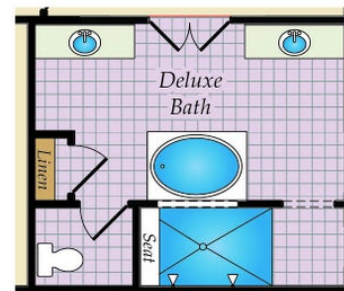

OPT. DELUXE BATH

OPTIONAL THIRD FLOOR

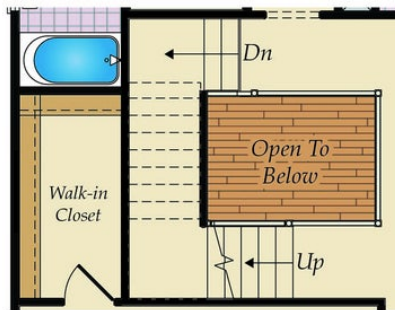

STAIRS ON SECOND FLOOR
W/ OPT. THIRD FLOOR

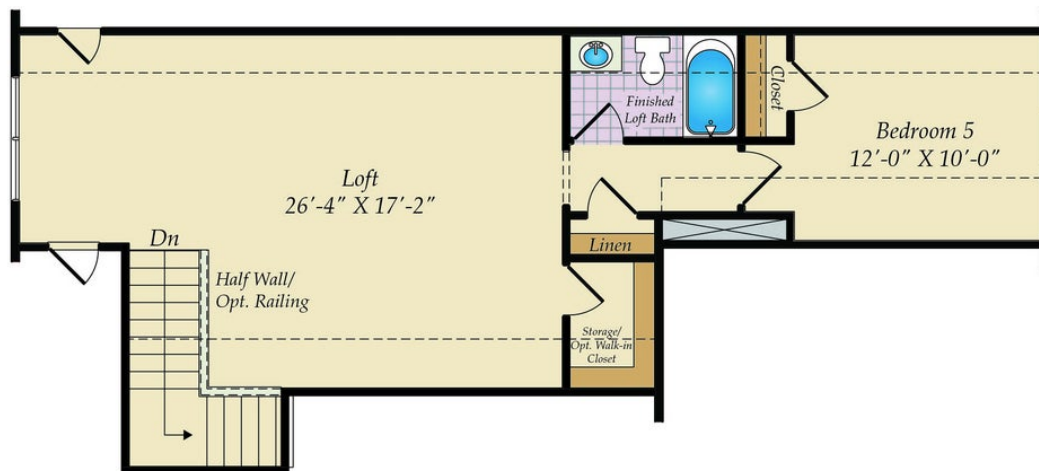

OPTIONAL THIRD FLOOR

OPTIONAL BASEMENT



FIRST FLOOR BASEMENT STAIRS

