

**4 Beds****3.5 Baths****3000 Sq Ft****ADDRESS**150 WOOLGRASS LANE - HOMESITE C169  
GETTYSBURG, PA 17325**SALES CONTACT**717-500-3767  
INFO@CARUSOHOMES.COM

Now is the perfect time to become part of this vibrant Active Adult community, featuring exceptional world-class amenities. [Click here](#) to learn more about all that Amblebrook has to offer!

Our newest Hayes floorplan is your new oasis at Amblebrook! Featuring 4 bedrooms, 3.5 baths, and 9' ceilings throughout, this home provides ample room for you and your family. Walking in to the Hayes, you can expect to find the following luxury upgrades, in addition to the included standard features:

- Premium Homesite
- Additional 2nd floor containing loft, two bedrooms, and full bath with custom soaking tub
- Gourmet Kitchen with stainless steel appliances
- Tray ceilings in Foyer & Primary Suite
- Primary Suite with 4' extension and en-suite bathroom with freestanding tub
- Sunroom addition
- Fireplace in Family Room

Many more grand features await you in this Hayes floorplan! Some photos have been virtually staged to better showcase the true potential of rooms and spaces in the home. See New Home Sales Consultant for a complete list of included features.

# FIRST FLOOR



OPT. OWNER'S TUB AND SHOWER



OPT. OWNER'S WALK IN SHOWER



OPT. BEDROOM 3 WITH FULL BATH

## OPTIONAL SKY BASMENT AND OPTIONAL BASMENT

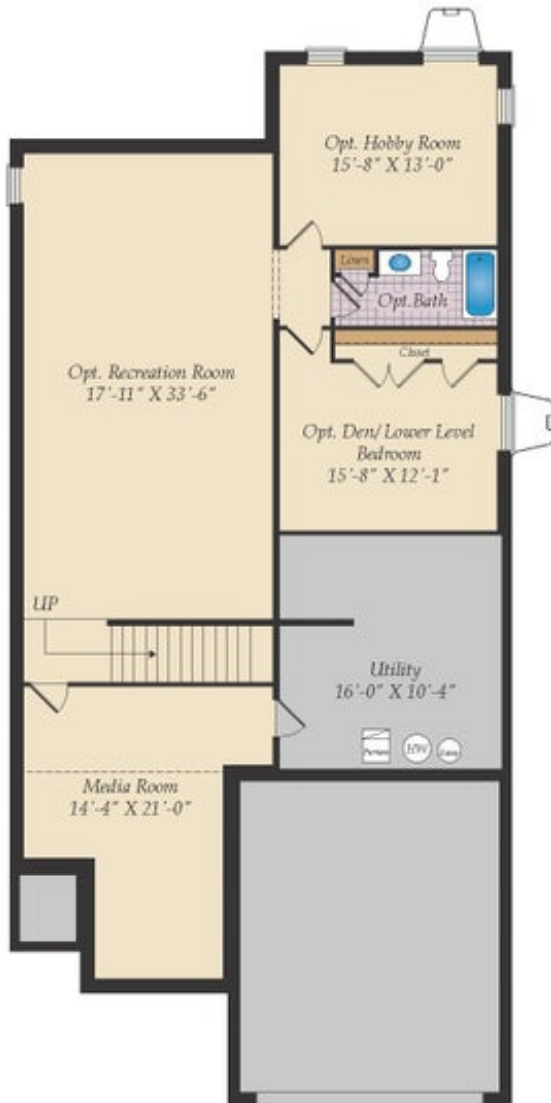

OPT. FINISHED BASEMENT

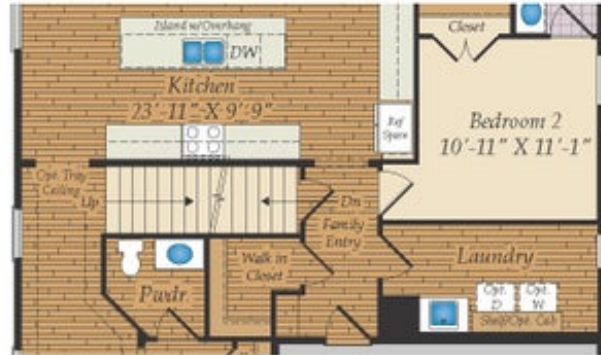

OPT. 1ST FLOOR W/OPTIONAL BASEMENT & OPT. SKY BASEMENT



OPT. SKY BASEMENT

# OPTIONAL SKY BASMENT AND OPTIONAL BASMENT

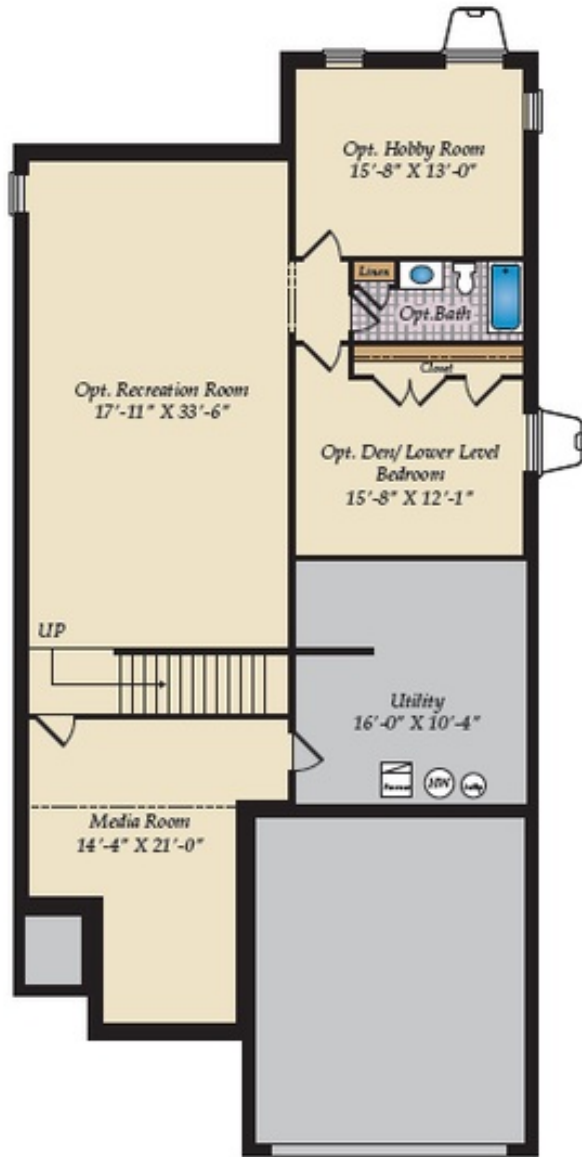

OPT. FINISHED BASEMENT  
(BASEMENT NOT AVAILABLE AT AMBLEBROOK, PA)

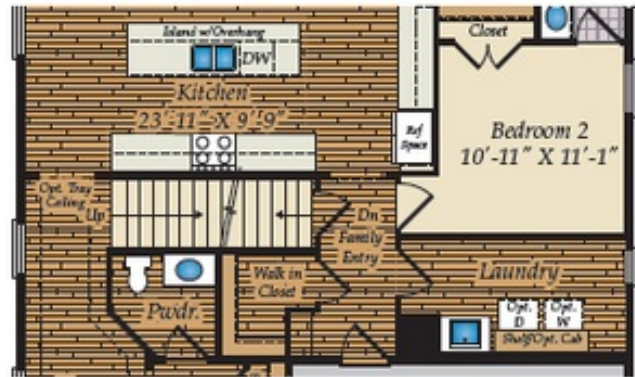

OPT. 1ST FLOOR W/OPTIONAL BASEMENT & OPT. SKY BASEMENT  
(BASEMENT NOT AVAILABLE AT AMBLEBROOK, PA)

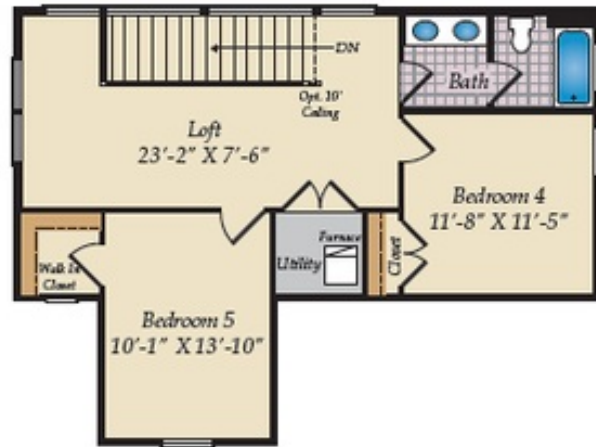

OPT. SKY BASEMENT



## OTHER OPTIONS



OPT. CONCRETE PATIO

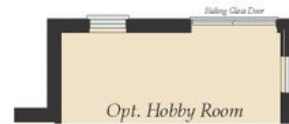

OPT. WALKOUT BASEMENT



OPT. SCREENED PORCH

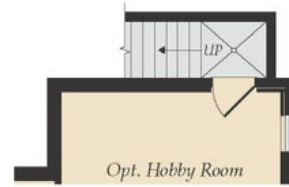

OPT. SINGLE AREAWAY



OPT. SUNROOM

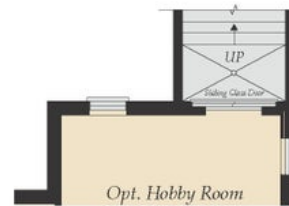

OPT. DOUBLE AREAWAY