



2 - 4 Beds

2 - 3 Baths

2,057 - 2,746 Sq Ft

COMMUNITY CONTACT

9 REEDGRASS WAY
GETTYSBURG, PA 17325
717-500-3767
INFO@CARUSOHOMES.COM

The Kelloway II is an updated version of our popular Kelloway floorplan. The Kelloway II is a cottage-style home that is part of our First Floor Owners Suite series. The layout features one-level living with an open floorplan, a large owner suite, a guest room and den. Add a sky basement for additional space and storage. Plenty of options are available to personalize this home.

Available Elevations



FIRST FLOOR

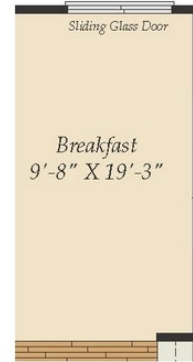

OPT. EXTENDED DINING ROOM

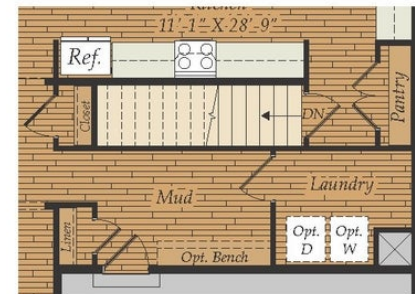

1ST FLOOR W/ OPT. BASEMENT
 (BASEMENT NOT AVAILABLE AT AMBLEBROOK, PA)

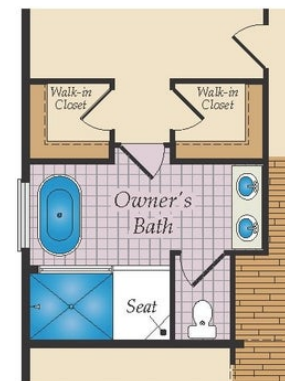

OPT. OWNER'S BATH W/TUB & SHOWER

Brick/stone fronts, chimneys, bay windows, keystones, exterior trim, garage doors, light fixtures, dormers, and gables shown on elevations are optional features. Actual product specifications may vary in dimension or detail from these drawings. This insert is for illustrative purposes only and is not part of the legal contract. All dimensions are approximate. Many available options are not shown.

OPTIONAL SKY BASEMENT & ADDITIONAL FEATURES

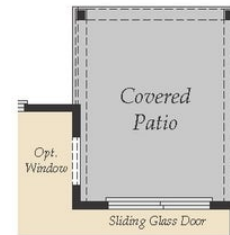
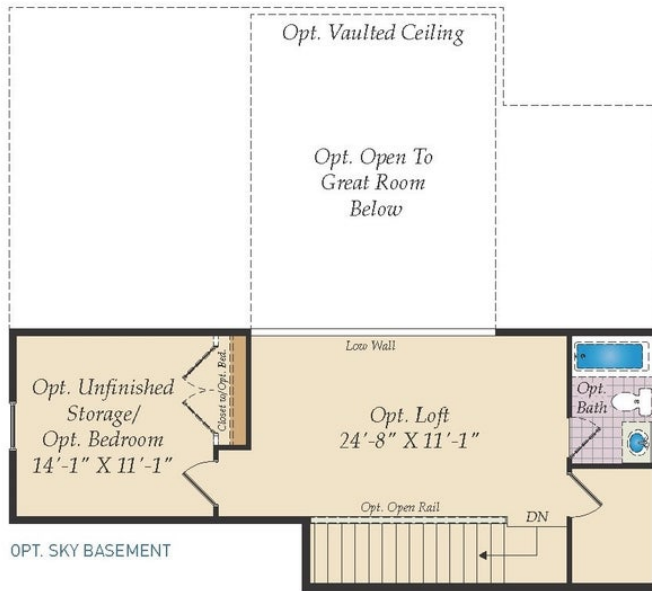

OPT. COVERED CONCRETE PATIO

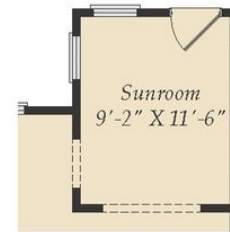

OPT. SUNROOM

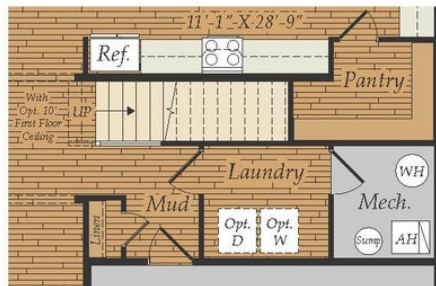

1ST FLOOR W/ OPT. SKY BASEMENT



OPT. SCREENED PORCH

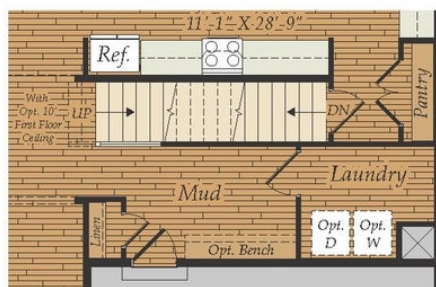

1ST FLOOR W/ OPT. SKY BASEMENT & BASEMENT
 (BASFMNT NOT AVAIL ABIF AT AMBIF BROOK, PA)